

Think high achieve high

One for Everyone



RERA:TN/01/LAYOUT/0217/2019  
www.tnrera.in

Prestigious Plots  
@  
**PADAPPAI TOWN**

**READY  
TO BUILD VILLA PLOTS**

**CYRIL  
CASTLE**



**Connectivity to :**

- ✓ Padappai Bus Terminal 1.5 kms
- ✓ Vandalur Railway Station 7 kms
- ✓ Oragadam Sipcot 7 kms
- ✓ proposed Urapakkam CMBT Bus Terminal 9 kms

**Features:**

- ✓ Clear Title
- ✓ Well Developed approved layout
- ✓ Road with Security Gate Arch
- ✓ Sweet Portable Ground Water at 10 ft
- ✓ 33 feet black top Road

**Near By :**

- ✓ Hospital
- ✓ CBSE & Matriculation School (Velammal CBSE (Alwin International School) (Nadesan Mat.School)
- ✓ Bazaar Road & Bus Stand
- ✓ Register Office & Marriage Hall

I5 HOUSING & PROPERTIES



Drawing showing the layout of  
 DTCP Approved 427/2019  
 Survey No.  
 173/8, 173/10, 173/11, 173/12,  
 173/13, 173/16,  
 SIRUMATHUR VILLAGE  
 SRIPERUMBUDUR TALUK  
 KANCHIPURAM DISTRICT

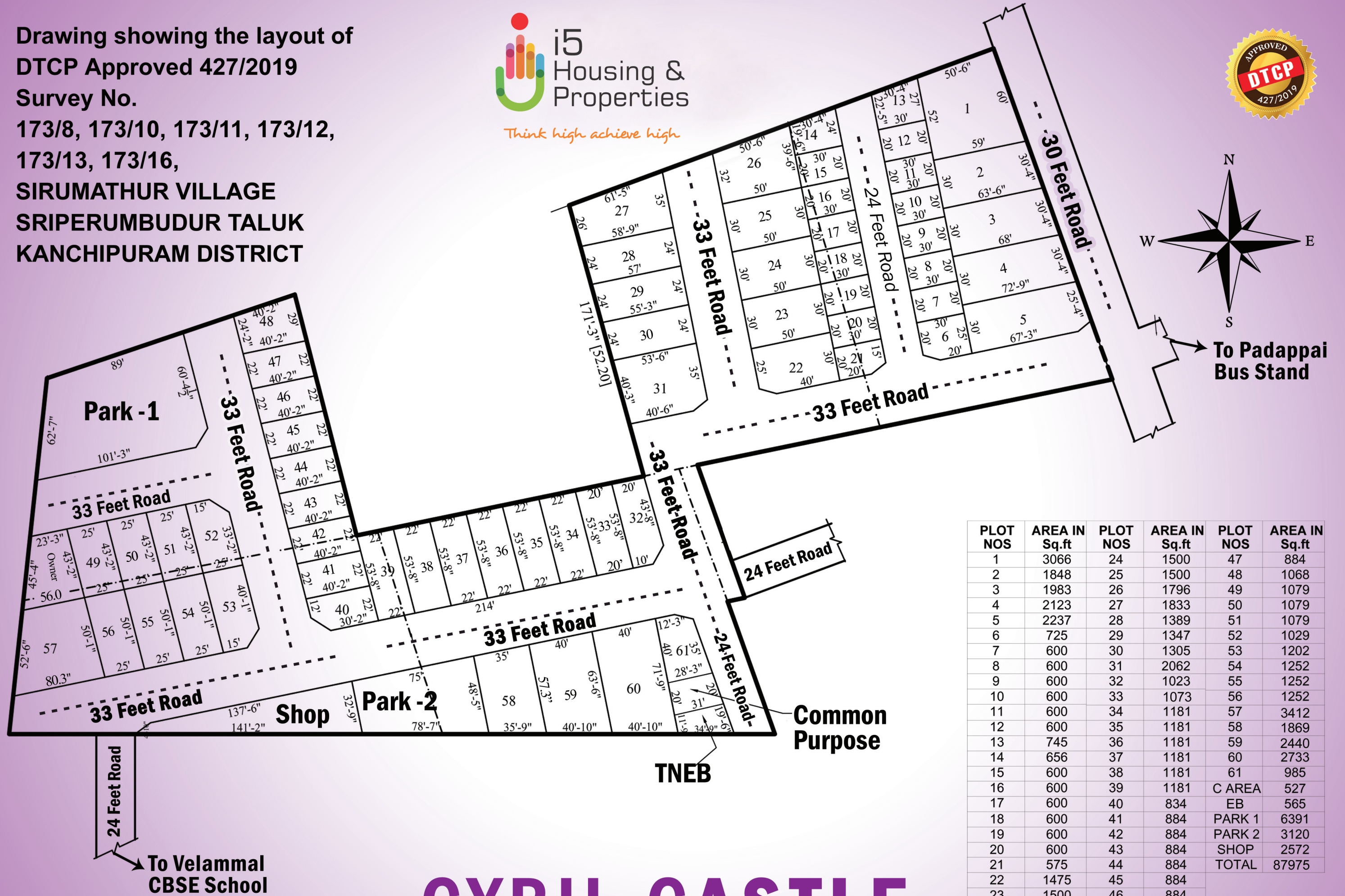

PLOT NOS	AREA IN Sq.ft	PLOT NOS	AREA IN Sq.ft	PLOT NOS	AREA IN Sq.ft
1	3066	24	1500	47	884
2	1848	25	1500	48	1068
3	1983	26	1796	49	1079
4	2123	27	1833	50	1079
5	2237	28	1389	51	1079
6	725	29	1347	52	1029
7	600	30	1305	53	1202
8	600	31	2062	54	1252
9	600	32	1023	55	1252
10	600	33	1073	56	1252
11	600	34	1181	57	3412
12	600	35	1181	58	1869
13	745	36	1181	59	2440
14	656	37	1181	60	2733
15	600	38	1181	61	985
16	600	39	1181	C AREA	527
17	600	40	834	EB	565
18	600	41	884	PARK 1	6391
19	600	42	884	PARK 2	3120
20	600	43	884	SHOP	2572
21	575	44	884	TOTAL	87975
22	1475	45	884		
23	1500	46	884		

# CYRIL CASTLE