

SHANTHIKETAN

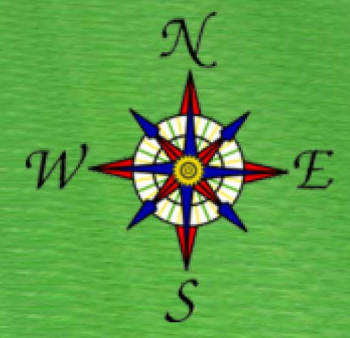

Aurum Garden



Location advantage:

Schools & Colleges around our project:

- ❖ Velammal International School – within 1 km.
- ❖ PSBB School
- ❖ Adarsh School
- ❖ Gateway International School
- ❖ Jagannath Vidyalaya School
- ❖ Delhi Public School
- ❖ Sushil Hari International Residential School
- ❖ Hindustan College
- ❖ SSN College

Hospital & Healthcare:

- ❖ Chettinad Health City (Within 1 km)
- ❖ Swaram Hospital

Entertainment

- ❖ Many top class Hotels, Restaurants & Malls Near by

IT Park & companies:

- ❖ Siruseri SIPCOT (10 mins),
- ❖ All major IT companies on OMR stretch (within 30 mins)
- ❖ Mahindra City (45 mins)

New upcoming mega projects in & around OMR:

- ❖ Japanese city, a 1500 acres industrial township (15 mins)
- ❖ IIT R & D Centre, a 160 acres project (5 mins)



Aurum Garden

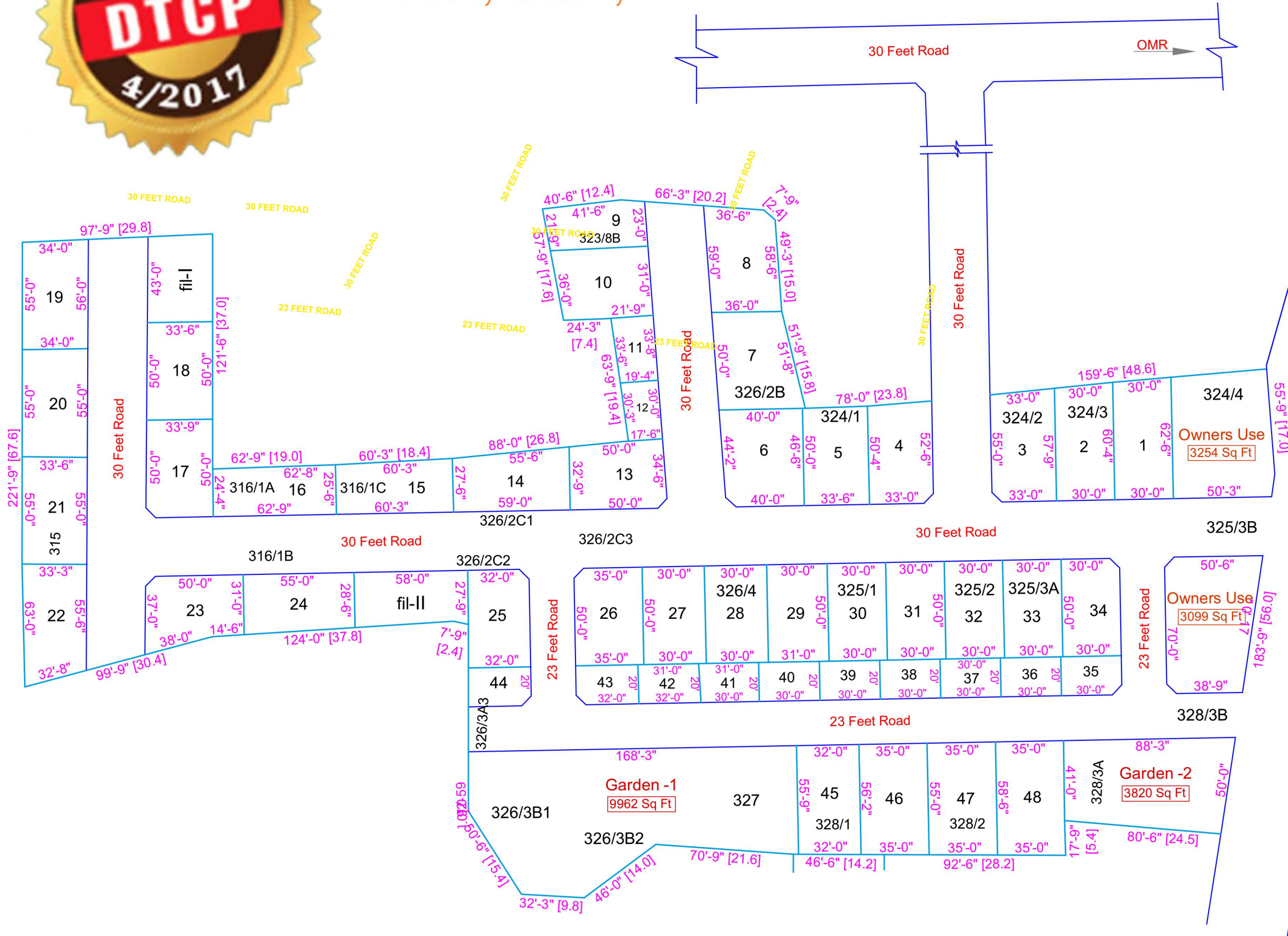
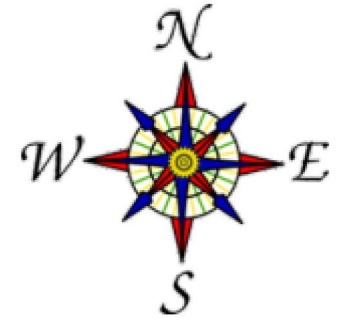

Plot No	Total Area (Sq Ft)	Plot No	Total Area (Sq Ft)
1	1840	25	1566
2	1771	26	1738
3	1848	27	1500
4	1684	28	1500
5	1672	29	1550
6	2053	30	1500
7	2006	31	1500
8	1912	32	1500
9	1192	33	1500
10	1727	34	1485
11	688	35	607
12	552	36	620
13	1660	37	620
14	1790	38	620
15	1593	39	620
16	1572	40	620
17	1691	41	608
18	1680	42	630
19	1877	43	628
20	1860	44	629
21	1836	45	1795
22	1903	46	1990
23	1720	47	2018
24	1682	48	2038